

## Installation of wet cross-over kit for R2 and R43/44 racks

The new guide should be mounted in the fixer rack in a way that secures that the surface of the film does not touch fixer before it enters the fixer chemistry.

Turn off the processor at the main switch and lock the switch prior to the replacement.  
Then lift up the rack(s) from the tank(s).

### Installation instructions for wet cross-over kit for R2 racks

Valid for the following processors:

EG 750: kit no. 316617

EG 900: kit no. 320617

Remove the 7/8" roller in the fixer inlet and the top guide in the fixer rack. See fig. 1.

After that mount the new roller in the fixer rack as shown at fig. 2.

Then place the fixer rack in the processor.

### Installation instructions for wet cross-over kit for R43/44 racks

Valid for the following processors:

EG 751: kit no. 129659

EG 901: kit no. 136659

Dismantle the two top inlet rollers and the inlet guide in the fixer rack as well as the two white guide forks in the developer rack. See fig. 3.

After that mount the two black guide forks from the kit in the developer rack in the position where the white guide forks were located.

Then mount the new inlet guide at the existing white guide forks on the fixer rack. See fig. 4.

Then place the dev- and fixer racks in the processor.

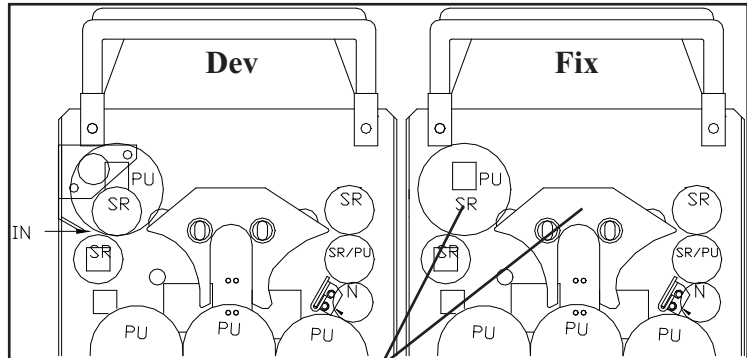

Fig. 1 Remove the roller and guide

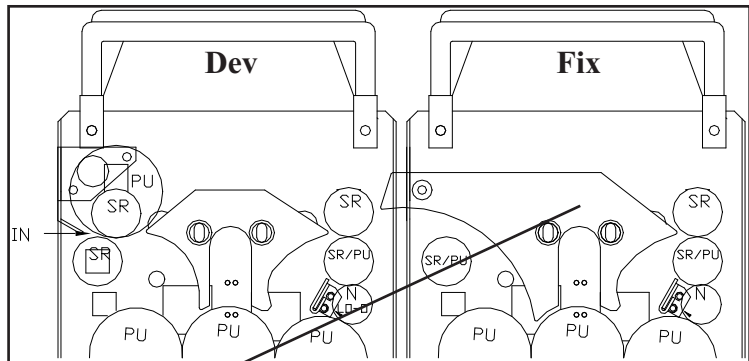

Fig. 2 New guide

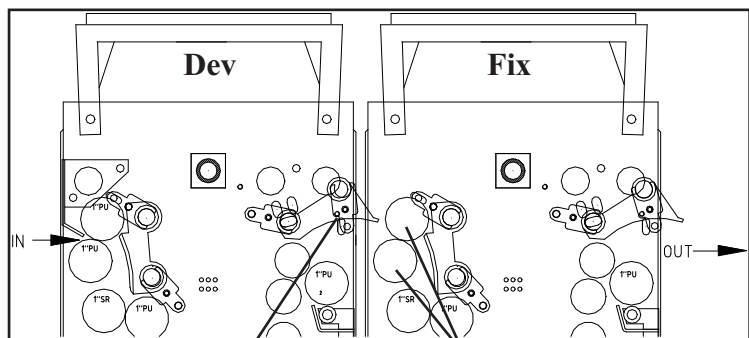

Fig. 3 Remove the guide fork Remove the rollers

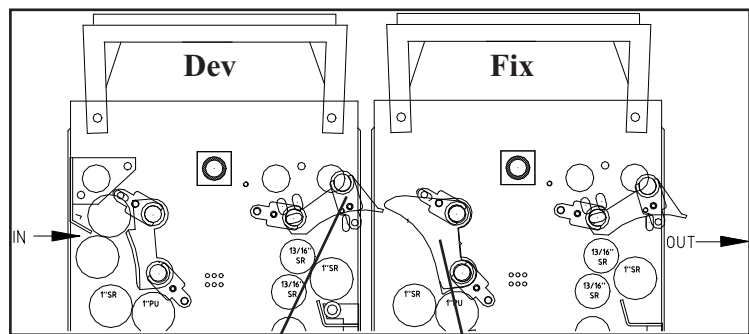

Fig. 4 New black guide fork New guide